

Installation Instructions

GTx™ LED Traffic Signal Internal Masks

200mm (8in) and 300mm (12in) Circular Modules



BEFORE YOU BEGIN

Read these instructions completely and carefully.

Prepare Electrical Wiring



Electrical Requirements

- Do not perform mask installation in wet locations
- Follow all National Electric Codes (NEC) and local codes.

⚠ WARNING / AVERTISSEMENT

Risk of Electric Shock. Disconnect Before Servicing or installing product. The LED module must be installed into a signal head with adequate ingress protection for the location (protection from the weather).

Risque de choc électrique. Couper l'alimentation avant le dépannage ou avant l'installation du produit.

Le module DEL doit être installé dans une tête de signal avec une protection adéquate d'entrée pour l'emplacement (protection contre les intempéries).



Removal of internal lens will void your warranty

IMPORTANT NOTICE: "Removal of the internal domed lens will void your warranty."

- Always **WEAR** gloves.
- **DO NOT** touch the front shell or internal domed lens at ANY TIME without gloves.
- **ALWAYS** Rest the front shell on something soft, to prevent scratching.
- Avoid dropping or leaving any debris in the lamp when it is open.
- Failure to properly follow these instructions may cause the signal to malfunction.

Mask Installation Steps:

1. **Remove gasket:** Pull the gasket up and out.
2. **Turn lamp over:** Lay the front shell on a cushioned surface to avoid scratching or damaging the surface.



Step 1



Cushioned surface

Step 2

3. **Unclip lamp:** Insert a thin flathead screwdriver slightly to one side of a clip and pry it outward. Repeat until all 8 clips are undone.
4. **Remove front shell:** Place the lamp on its back housing and locate the back housing locating feature.



Step 3



Back housing locating feature



Step 4

Installation Instructions (cont'd)

GTx™ LED Traffic Signal Internal Masks

Instructions for Single Piece Masks



5. For single piece masks  proceed to step 6. For two-piece arrow masks  go to step 7.

6. **Align mask:** Align the locating features on the mask and back housing, and place the mask on the back housing. The mask will not rotate if the locating features are aligned correctly. **Proceed to step 8.**



Instructions for Two Piece Arrow Masks



7. For two-piece arrow masks which consist of:

- the crown (the hollow circular plastic part)
- the arrow mask (the directional arrow which fits on top of the crown)

a. **Orient Crown:** Align the locating features on the crown and back housing. Place the crown on the back housing. The crown will not rotate if the locating features are aligned correctly.

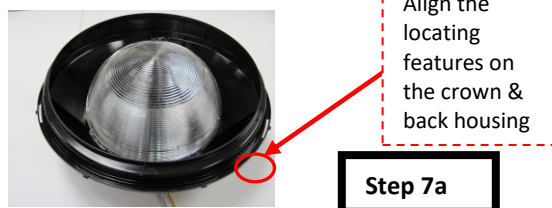
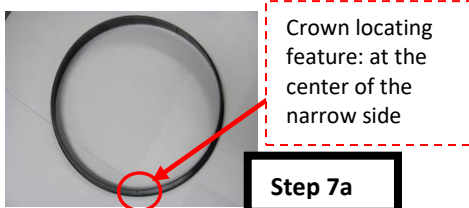

b. **Orient arrow mask:** Align the locating features on the mask (Arrow) and crown. There are 16 locating features to give orientation options for different directions. Once the appropriate direction is selected place the mask (Arrow) on top of the crown. The mask (Arrow) will not rotate if the locating features are aligned correctly.

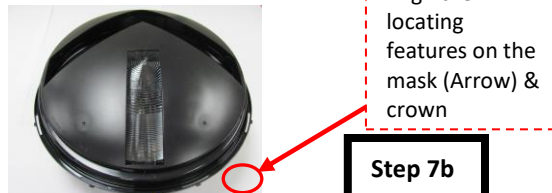
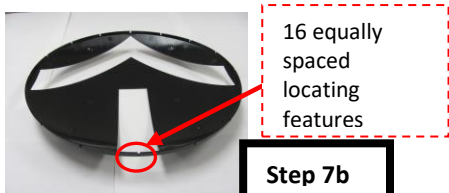

Installation Instructions (cont'd)

GTx™ LED Traffic Signal Internal Masks

8. **Close lamp:** Clip the front shell onto the back housing by aligning the locating features at the top of the back housing and the top of the shell, then squeeze the two together at each clip until you hear a click.



9. **Verify sealing:** Turn the lamp upside down to check that all 8 clips are engaged.

10. **Ensure proper sealing:** Squeeze the flange between the clips to completely seal the lamp.



11. Reinstall the gasket (refer to Step 1).

This product is intended solely for the use of traffic signaling and is not intended for use in any other applications.

NOTE: If you prefer to have this Installation Instructions document in **other languages**, visit our official website at:

www.currentbyge.com/transportation

This device complies with part 15 of the FCC Rules. Operation is subject to the following two conditions: (1) This device may not cause harmful interference, and (2) this device must accept any interference received, including interference that may cause undesired operation. CAN ICES-005(A)/NMB-005(A)
NOTE: This equipment has been tested and found to comply with the limits for a Class A digital device, pursuant to part 15 of the FCC Rules. These limits are designed to provide reasonable protection against harmful interference when the equipment is operated in a commercial environment. This equipment generates, uses, and can radiate radio frequency energy and, if not installed and used in accordance with the instruction manual, may cause harmful interference to radio communications. Operation of this equipment in a residential area is likely to cause harmful interference in which case the user will be required to correct the interference at his own expense.

Current, powered by GE is a business of the General Electric Company. The GE and Current, powered by GE brands and logos are trademarks of the General Electric Company.
© 2016 General Electric Company. Information provided is subject to change without notice. All values are design or typical values when measured under laboratory conditions.

99003897 TRAF203-R200917 (DD/MM/YY)