

# Lumination™ LED Luminaires

Retrofit Commercial Downlights  
New Construction Frame Kit



Project name \_\_\_\_\_

Date \_\_\_\_\_

Type \_\_\_\_\_

## Product Description:

The non-IC rated frame kits are designed to enable 4", 6" and 8" retrofit downlight fixtures to be used in new construction applications. The square frame has an adjustable aperture for easy installation. Suitable for grid or drywall ceilings. Hanger bars accessories available for installation in T-grid ceilings.

## Performance Summary:

**Mounting Options:** Hanger bars for T-grid or drywall ceilings

**Limited Warranty:** 5 years system

### 4" Round:

A = 12.91" [328 mm]

B = 8.58" [218 mm]

C = 4.80" [122 mm]

### 4" Square:

A = 12.91" [328 mm]

B = 8.58" [218 mm]

C = 5.04" [128 mm] x 4.02" [102 mm] ~ 5.04" [128 mm]

### 6" Round:

A = 15.35" [390 mm]

B = 11.34" [288 mm]

C = 6.27" [159.30 mm]

### 6" Square:

A = 15.35" [390 mm]

B = 11.34" [288 mm]

C = 6.70" [170 mm] x 5.91" [150 mm] ~ 6.80" [172.6 mm]

### 8" Round:

A = 15.35" [390 mm]

B = 11.34" [288 mm]

C = 7.87" [200 mm]

### 8" Square:

A = 15.35" [390 mm]

B = 11.34" [288 mm]

C = 8.27" [210 mm] x 7.48" [190mm] ~ 8.37" [212.6mm]

**Height:** 3.72" [94.50 mm]

Listings: 

a product of  
**ecomagination™**

- Suitable for damp locations.

## Ordering Information:

FRAME KIT SKU	MATERIAL DESCRIPTION	RECESSED CAN SIZE
93090208	FRAME4R	4" ROUND RETROFIT DOWNLIGHT
93025091	FRAME6R	6" ROUND RETROFIT DOWNLIGHT
93025092	FRAME8R	8" SQUARE RETROFIT DOWNLIGHT
93090209	FRAME4S	4" SQUARE RETROFIT DOWNLIGHT
93045426	FRAME6S	6" SQUARE RETROFIT DOWNLIGHT
93045427	FRAME8S	8" SQUARE RETROFIT DOWNLIGHT

## Product Dimensions:

### Round Frame Kit

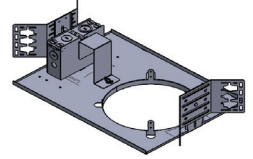
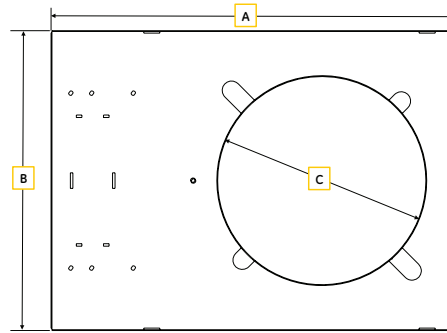

### Square Frame Kit

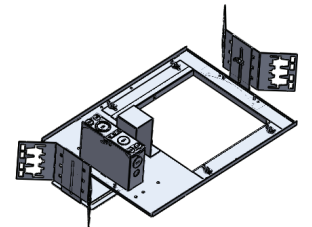
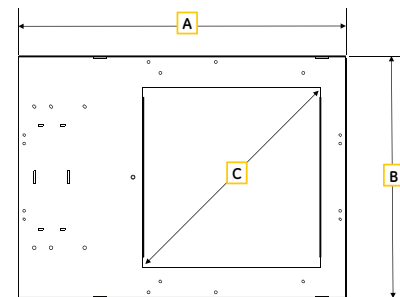

HANGER BAR SKU	MATERIAL DESCRIPTION	PRODUCT DESCRIPTION
94890	BH3	C-CHANNEL - 25 1/4", HANGER BAR (QUANTITY 2)

## Product Specifications:

### Compatibility:

Intended for use with the following fixtures:

#### Round

- GE Lumination LRX Round Series
- GE Lumination LRC Round Series
- GE Lumination RI Round Series

#### Square

- GE Lumination LRX Square Series

### Installation:

- Universal mounting brackets with over 3" of vertical adjustment accommodate several types of hanger bars
- C-channel bar hanger is provided for mounting to T-bar grid
- Mount in T-bar grid or drywall ceilings, up to 1.5" thick

### Construction:

- 22 gauge galvanized steel housing
- Galvanized steel junction box with multiple knockouts for the RC and RX fixtures

For more information and access to all of our resources, including our design tool visit: [www.gelighting.com](http://www.gelighting.com)

**current**  
powered by GE

All trademarks are the property of their respective owners. Information provided is subject to change without notice. All values are design or typical values when measured under laboratory conditions. Current, powered by GE is a business of the General Electric Company.  
© 2017 GE.

[www.currentbyge.com](http://www.currentbyge.com) | IND272 (Rev 06/27/17)

